

PF-TFN

Pressacavo con testa filettata per cavo non armato con filetto femmina fisso
Cable gland with threaded head for non-armoured cable with fixed female thread

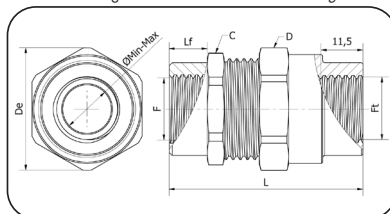

Disegno tecnico / Technical drawing



Settori di Impiego / Areas of application



SIZE ID	Filetto cilindrico / Cylindrical thread					L (mm)	øDe (mm)	Filetto Thread Metrico ISO 965-1	Esagono Hexagon		Gommino di tenuta Sealing rubber	Cavi Cables	Conf. Pack.		
	Codice Code	Filetto Thread GAS ISO 228	Codice Code	Filetto Thread Metrico ISO 965-1	Lf (mm) filetto Thread				C	D				Cavi Cables	
														F	F
A2	Ex46941	GAS 3/8"	Ex46901	M16x1,5	10,0	46	29	M16x1,5	24	26	A B C	5,0 - 7,0 7,0 - 9,0 9,5 - 11,5	5		
A3	Ex46942	GAS 1/2"	Ex46902	M20x1,5	10,0	47	32,5	M20x1,5	27	29	A B C	5,5 - 8,0 8,0 - 10,5 10,5 - 13,0	5		
A4	Ex46943	GAS 3/4"	Ex46903	M25x1,5	10,0	48	38,5	M25x1,5	33	35	A B C	10,5 - 13,0 13,0 - 15,5 15,5 - 18,0	3		
A5	Ex49644	GAS 1"	Ex46904	M32x1,5	12,0	56	49,5	M32x1,5	42	45	A B C	15,5 - 18,0 18,0 - 20,5 20,5 - 23,0	3		
A6	Ex46945	GAS 1" 1/4	Ex46905	M40x1,5	12,0	62	60	M40x1,5	52	54	A B C D	21,0 - 24,0 24,0 - 27,0 27,0 - 30,0 30,0 - 33,0	1		
A7	Ex46946	GAS 1" 1/2	Ex46906	M50x1,5	14,0	69	69	M50x1,5	60	62	A B C	27,0 - 30,0 30,0 - 33,0 33,0 - 36,0	1		
A8	Ex46947	GAS 2"	Ex46907	M63x1,5	14,0	78	89	M63x1,5	75	80	A B C D	36,0 - 39,0 39,0 - 42,0 42,0 - 45,0 46,5 - 49,5	1		

Dettagli pressacavi / Cable glands details

Tipo di certificazioni Certification type	Organismo di notifica Notification body	Gruppo di dispositivi Device Group	ATEX Categoriche ATEX Category	Esecuzioni Execution	EPL	Grado IP IP Rating	Norme di riferimento Reference norms	Tipo di cavo Cable type	Zone Zona	Disponibile ingresso filetto Available thread entry	Temperatura di esercizio Operating temperature
IECEx		-		Ex eb IIC	Gb	IP66 / IP67	IEC 60079-0, IEC 60079-7, IEC 60079-15, IEC 60079-31	Non armato Non armoured	1 zone	ISO 965-1, GAS ISO 228	-35°C +85°C
				Ex nR IIC	Gc	IP68 (0.5bar, 30 min)			2 zone		
				Ex tb IIIC	Db	IP 6X 20 mbar			21 zone		
Ex	0051	II	2G	Ex eb IIC	Gb	P66 / IP67	EN IEC 60079-0, EN IEC 60079-7, EN IEC 60079-15, EN IEC 60079-31		22 zone		
				Ex nR IIC	Gc	IP68 (0.5bar, 30 min)					
				Ex tb IIIC	Db	IP 6X 20 mbar					

Esempio di marcatura pressacavo Ex / Example of Ex cable gland marking

IECEx IMQ 24.0004X IMQ 24 ATEX 012 X (eb,tb) IMQ 24 ATEX 013 X (nR) PF-TFN A2 - Ex46901AEM M16x1.5

CE Ex 0051 II 2GD Ex eb IIC Gb Ex tb IIIC Db || II 3G Ex nR IIC Gc -35/+85 °C IP66/68



Ex Apparecchiatura

Ex Equipment

scarica le istruzioni di montaggio
download assembly instructions



Dettagli di costruzione / Construction Details:

N°	Nome / Part Name	Materiale / Material
1	Corpo / Body	Ottone nichelato / Brass nickel plated
2	Rondella di uscita / End washer	Ottone nichelato / Brass nickel plated
3	Gommino di tenuta / Sealing rubber	EPDM
4	Rondella d'ingresso / Entry washer	Ottone nichelato / Brass nickel plated

N°	Nome / Part Name	Materiale / Material
5	Testina filettata / Threaded head	Ottone nichelato / Brass nickel plated
6	Morsetto EMC / EMC clamper	Ottone / Brass

Pressacavo con testa filettata per cavo non armato con filetto femmina fisso
Cable gland with threaded head for non-armoured cable with fixed female thread

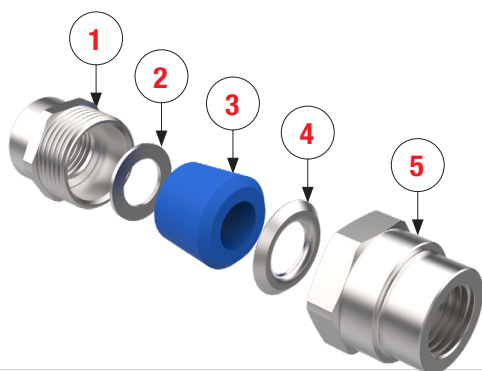

ESEMPIO D'ORDINE / EXAMPLE ORDERING

Codice d'ordinazione

Ordering code

Ex46901A

Ex46901

A

Product code
Codice prodotto

A / B / C / D = Select one sealing rubber
Selezionare una gommino di tenuta

Pressacavo con testa filettata per cavo non armato con filetto femmina fisso con compatibilità EMC
Cable gland with threaded head for non-armoured cable with fixed female thread with EMC compatibility

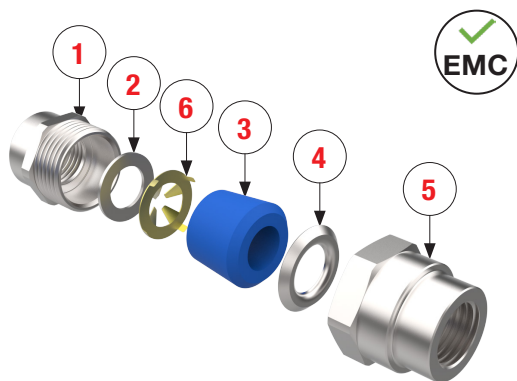

ESEMPIO D'ORDINE / EXAMPLE ORDERING

Codice d'ordinazione

Ordering code

Ex46901AEM

Ex46901

A

EM

Product code
Codice prodotto

EM = EMC for non-armoured cable glands
EMC per pressacavi non armati

A / B / C / D = Select one sealing rubber
Selezionare una gommino di tenuta

Gommino di tenuta / Sealing rubber								
SIZE ID	Codice Code	Cavi Cables	Conf. Pack. N° Pz	SIZE ID	Codice Code	Cavi Cables	Conf. Pack. N° Pz	
A2	Ex34202	A	5,0 - 7,0	A6	Ex34306	A	21,0 - 24,0	5
	Ex34102	B	7,0 - 9,0		Ex34106	B	24,0 - 27,0	
	Ex34002	C	9,5 - 11,5		Ex34206	C	27,0 - 30,0	
	-	-	-		Ex34006	D	30,0 - 33,0	
A3	Ex34203	A	5,5 - 8,0	A7	Ex34207	A	27,0 - 30,0	5
	Ex34103	B	8,0 - 10,5		Ex34107	B	30,0 - 33,0	
	Ex34003	C	10,5 - 13,0		Ex34007	C	33,0 - 36,0	
A4	Ex34204	A	10,5 - 13,0	A8	Ex34208	A	36,0 - 39,0	5
	Ex34104	B	13,0 - 15,5		Ex34108	B	39,0 - 42,0	
	Ex34004	C	15,5 - 18,0		Ex34308	C	42,0 - 45,0	
	-	-	-		Ex34008	D	46,5 - 49,5	
A5	Ex34205	A	15,5 - 18,0	-	-	-	-	-
	Ex34105	B	18,0 - 20,5	-	-	-	-	-
	Ex34005	C	20,5 - 23,0	-	-	-	-	-