

PA MRN Mounting Rail with Slot Nuts

EURO 2000



Areas of application



DESCRIPTION

The FIPLOCK® mounting rail PA MRN offers easy installation and arrangement of the FIPLOCK® conduit mounting clip PA HC. The corresponding slot nut PA MRN can be easily applied to the required fixing position and locked with a simple finger push. Using a screwdriver the slot nut can be released and re-positioned again. The mounting rails can be connected with each other for extension and be cut with a standard conduit cutting plier to the required over-all length.

TECHNICAL SPECIFICATION

Different performances	Characteristics	Unit	Standards, Specifications	Remark
Application performances				
Temperature range	-50 bis / to +120 -58 bis / to +248	°C °F	IS FIP	-
Temperature (short-term)	150 (500 h); 165 (100 h) 302 (500 h); 329 (100 h)	°C °F	IS FIP	-
Fire safety performances				
Free from halogens and cadmium	Yes	-	-	-
Fire classification	V0	-	UL 94	-
Fire characteristic of the product	self-extinguishing	-	UL 1696	-
Oxygen index	>32	%	EN ISO 4589-2	-
Glow wire test	960 1760	°C °F	IEC 60695	-
Fire hazardous level	HL3	-	EN45545-2	-
Spread of fire	non flame propagating	-	IEC EN 61386	-
Weathering performances				
UV and weathering performance	very good	-	IS FIP	15 to 20 years



Assembly instruction mounting rail with slot nuts

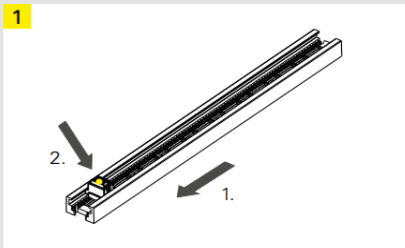

1. Insert the slot nut until it reaches the desired position and 2. press with your thumb until it snaps in.

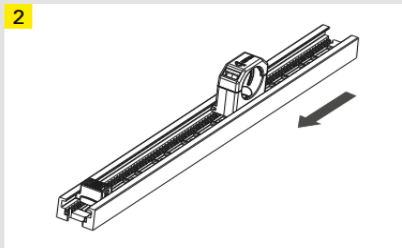

Insert the COPA-S mounting clips into the rail. (several mounting clips can be inserted in various nominal widths)

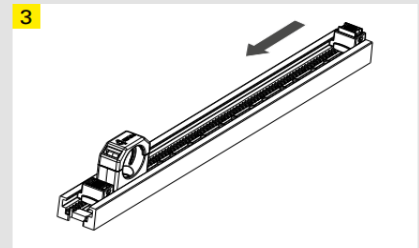

Insert the second slot nut from the opposite side.

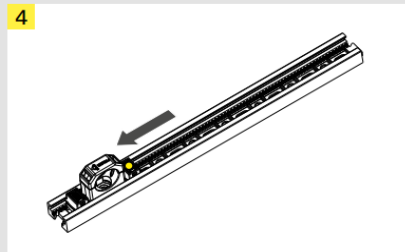

Press the slot nut against the COPA-S mounting clip with your thumb and at the same time close / lock the slot nut.

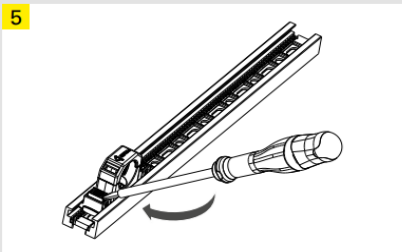

Releasing of the slot nut with a commercial screwdriver.

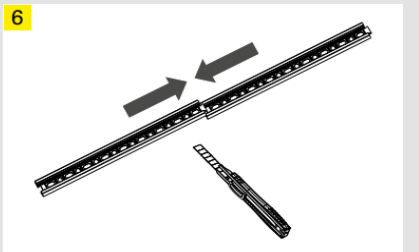

Assemble the dovetail connection to extend the mounting rail. Trim to the desired length with a suitable cutting tool.

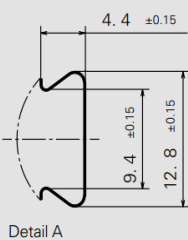
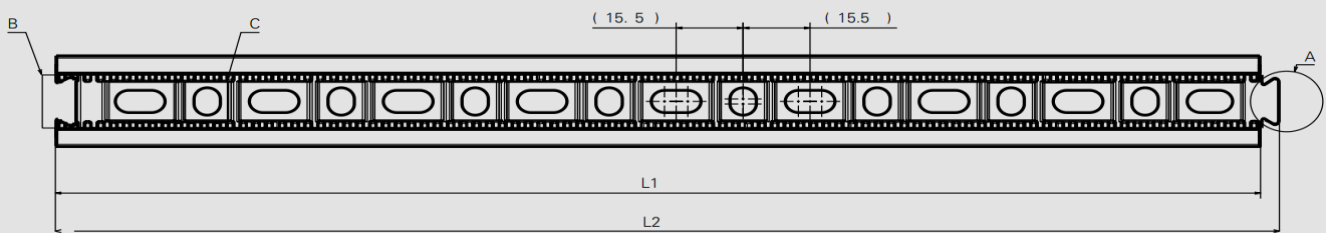

Detail A

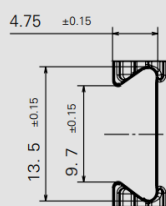

Detail B

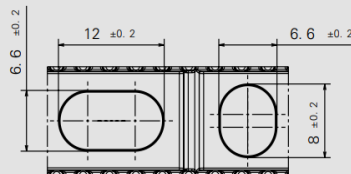

Detail C

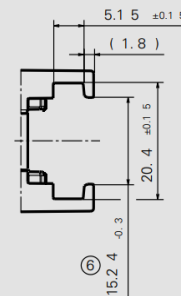

Detail D

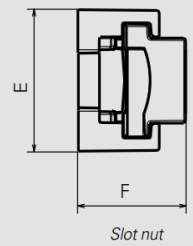

Slot nut

FAMILY CODE	Mounting Rail		Dimensions in mm						Weight/PU	Pack
	Code Black	Code Grey	L1	L2	Detail A	Detail B	Detail C	Detail D	g	Stk / Pcs
PA MRN / CRPA	PCR00B	PCR00G	279,0	283,0	see drawing	see drawing	see drawing	see drawing	37,3	4*

*including 10 pieces of PA MRN / CXPA

FAMILY CODE	Slot Nut		Dimensions in mm		Weight/PU	Pack
	Code Black	Code Grey	E	F	g	Stk / Pcs
PA MRN / CXPA	PCX02B	PCX02G	25	20	41,7	10

