

## Tappi Plugs

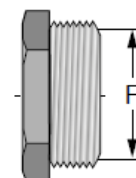

### Settori di Impiego / Areas of application



### DESCRIZIONE / DESCRIPTION

Tappi in ottone nichelato disponibili nelle filittature GAS, PG e ISO Metrica.

Nickel-plated brass plugs available in the thread versions: GAS, PG and ISO Metric.

### DATI TECNICI / TECHNICAL DATA

<b>Materiale / Material</b>	Ottone Nichelato / Nickel-plated brass
-----------------------------	--

Codice Code	Filetto GAS GAS Thread	Codice Code	Filetto PG PG Thread	Codice Code	Filetto ISO ISO Thread	Confezione Package
60501	1/4"	60521	7	60538	M12*1,5	50
60502	3/8"	60522	9	60531	M16*1,5	50
60503	1/2"	60523	11	60532	M20*1,5	50
60504	3/4"	60524	13,5	60533	M25*1,5	25
60505	1"	60525	16	60534	M32*1,5	10
60506	1"1/4	60526	21	60535	M40*1,5	5
60507	1"1/2	60527	29	60536	M50*1,5	5
60508	2"	60528	36	60537	M63*1,5	5
-	-	60529	42	-	-	5
-	-	60530	48	-	-	5